

Advanced IP Phone with 3 lines & HD voice

- TI TITAN chipset and TI voice engine
- 3 VoIP accounts, 132x64 graphic LCD
- HD Voice: HD Codec, HD speaker, HD handset
- BLA/BLF, XML Phonebook.
- 6 DSS keys, 2xLAN, Headset, Expansion module



The IP400 is designed for maximum efficiency and productivity in the everyday business environment.

It comes equipped with the TI-TITAN chipset and delivers high definition voice quality to the handset and speaker via the G-722 HD codec.

With 3 VoIP accounts and 6 DSS program keys, the IP400 can support IPBX features like busy lamp field, call park, call pickup, paging and voice recording.

The large graphic LCD is interfaced with 4 soft keys and a 4 way navigation key array for ease of use. The interfaces include 2 x LAN, Headset and DSS expansion module ports.

Phone Features

3 VoIP accounts, Hotline, Emergency call
Call hold, Call waiting, Call forward, Call return
Call transfer (blind/semi-attended/attended)
Caller ID display, Redial, Mute, DND
Auto-answer, 3-way conferencing
Speed dial, SMS, Voicemail
Message Waiting Indication (MWI) LED
Tone scheme, Volume control
Direct IP call without SIP proxy
Ring tone selection/import/delete
Phonebook (300 entries), Black list
XML phonebook search/import
Call history: dialled/received/missed/forwarded
Menu-driven user interface
Localised language and input method
Hard keys programmable at idle status
Supports up to 6 expansion modules

IP PBX System Integration

Busy lamp field (BLF)
Bridged line appearance (BLA)
Intercom, Paging
Music on hold
Call park, Call pickup
Call recording
Call completion
Group listening, Group pickup
Anonymous call
Anonymous call rejection
Distinctive ringtone
Dial Plan
Dial-now

Management

Configuration: browser/phone
Factory configuration customised
Trace package and system log export

Security

VLAN QoS (802.1pq), ToS, DSCP
HTTPS (client)
SRTP (RFC3711)
Digest authentication using MD5/MD5-sess
Secure configuration file via AES encryption
Phone lock for personal, Privacy protection

Codecs and Voice Features

Wideband codec: G.722
Narrowband codec: G.711 μ /A, G.723.1
G.726, G.729AB
VAD, CNG, AEC, PLC, AJB, AGC
Full-duplex speakerphone with AEC

Network Features

SIP v1 (RFC2543), v2 (RFC3261)
NAT Traversal: STUN mode
DTMF: In-Band, RFC2833, SIP Info
Proxy mode and peer-to-peer SIP link mode
IP Assignment: Static/DHCP/PPPoE
Bridge/router mode for PC port
TFTP/DHCP/PPPoE client
Telnet/HTTP server
DNS client, NAT/DHCP server

Physical Features

TI TITAN chipset
132x64 graphic LCD with backlight
39 keys including 11 function keys
6xDSS keys each with a dual-colour LED
9 LEDs: 6xDSS keys, 1xpower, 1xmessage
1xheadset
1xRJ9 (4P4C) handset port
1xRJ9 (4P4C) headset port
2xRJ45 10/100M Ethernet ports
1XRJ12 (6P6C) EXT port
Power adapter: AC 100~240V input and DC 5V/1.2A output
Detachable foot stand, Wall-mountable
Power over Ethernet (IEEE 802.3af)
Power consumption: 1.6-2.6W
Net weight: 0.77kg
Dimension: 265 x 128 x 210mm
Operating humidity: 10~95%
Storage temperature: up to 60°C

Package Features

Qty/CTN: 10 PCS
N.W/CTN: 7.553KG
G.W/CTN: 10.703KG
Measurement: 0.051CMB
Carton Meas: 665 x 545 x 220MM

Certifications

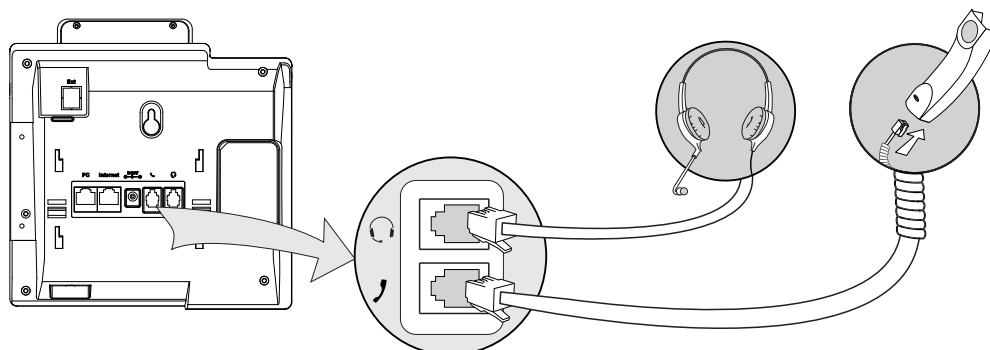
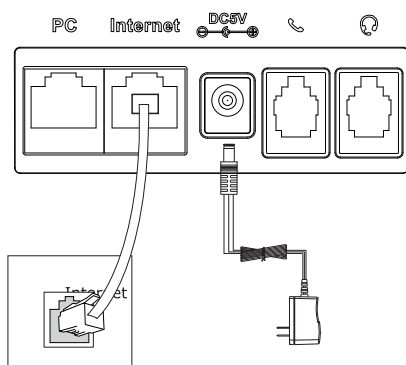

Aristel Networks P/L
Unit 1, 25 Howleys Road Notting Hill VIC 3168
Ph: 03 8542 2300 Fax: 03 9544 3299
Free Call: 1800 002 133
www.aristel.com.au
www.ipabx.com.au